



INTUIS™ Life

User Guide
Behind-the-Ear System

SIEMENS

Congratulations !

As the owner of a new hearing system, you may once again enjoy the sounds of your environment, and conversation with your family and friends.

These instructions as well as guidance from your hearing instrument specialist will help you understand how your new hearing system works. In this guide, you'll find instructions about insertion, removal and use of your INTUIS™ hearing system. There are also tips and information on proper handling, cleaning, care and changing of the batteries. In addition, a troubleshooting section is offered for your reference.

Your hearing improvement with a hearing system depends on the fit of the hearing instruments, the type and degree of hearing loss, and proper diagnostic testing. Of course, a hearing system cannot restore normal hearing, and not everyone will benefit equally.

More than 80 percent of individuals with a hearing loss have a hearing loss in both ears. Studies show that even when a hearing loss is worse in one ear, most people with a hearing loss in both ears will benefit from wearing two instruments.

Remember, a hearing system consists of finely-tuned devices that have been specially designed and expertly adjusted for your individual needs. Proper care and handling will ensure the best possible performance of your INTUIS™ hearing system.

Contents

	Page
<u>Your INTUIS™ Life BTE (behind-the-ear) hearing system</u>	<u>4</u>
<u>Battery insertion and removal</u>	<u>5</u>
<u>Inserting and removing your INTUIS Life</u>	<u>8</u>
<u>Turning your INTUIS Life on and off</u>	<u>9</u>
<u>Maintenance and care</u>	<u>10</u>
<u>Important notes</u>	<u>11</u>
<u>Troubleshooting tips</u>	<u>12</u>

Your INTUIS Life BTE (behind-the-ear) hearing system

INTUIS Life



Optional: Standard earhook



Hearing system for mild to moderate hearing loss

Features

- | | |
|-----------------------|--|
| 1. LifeTube | 6. Cover for programming socket |
| 2. LifeTip | 7. Battery compartment |
| 3. LifeTip Adapter | 8. Color-coded typeplate
red = right instrument
blue = left instrument |
| 4. Earhook (optional) | |
| 5. Microphone opening | |

Note:

- Always wear the LifeTube with the LifeTip.
- Make sure that the LifeTip is completely attached to the LifeTip Adapter.
- Change the LifeTube or LifeTip when they become cracked.
- Put the LifeTube with the LifeTip carefully and not too deep into the ear.
- Use the LifeTube and LifeTip only in the way described in this user guide.

Battery insertion and removal

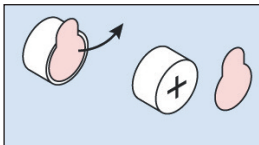

Handling the battery

The protective tab on your battery should only be removed when you are ready to use the battery.

Three useful tips:

- The positive (+) side of the battery is always the smooth side. You can recognize the negative (-) side by the colored ring.
- Always keep spare batteries with you
- If you feel you cannot change the battery by yourself, ask someone to help you: a family member, friend or your hearing instrument specialist.

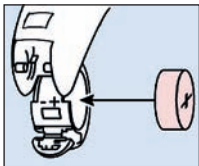
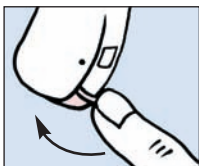

Inserting the battery

Open the battery compartment with your fingernail as shown in the illustration.

Swivel open the battery compartment door, if not already open. Place the proper size battery (Type 312) so that the "+" symbol on the battery matches the "+" marked on the battery compartment.



Gently close the battery compartment by pressing the bottom of the door upward with your finger tip. Do not force the door shut. If it does not close easily, check to see if the battery was inserted properly. When the battery door is completely closed, your hearing instrument is ready for use.

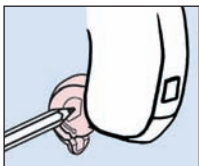

Removing the battery

Normally the battery drops out when the compartment is completely open. If the battery does not come out, lightly tap the system or push the battery out with a pencil as shown.

Low battery indicator

Your hearing system may be programmed to inform you when the battery should be replaced for best system performance. You may hear an intermittent series of beeps and/or experience low amplification power or volume. Change the battery when either of these occurs.

Power-on-delay

Your INTUIS Life hearing instrument may be equipped with a “power-on-delay” feature. In this case the hearing system is automatically turned on after a delay of 12 seconds, so that you may insert the hearing instrument into your ear without experiencing unpleasant feedback (whistling)

Caution:

Keep batteries and instruments away from the reach of small children.

Batteries can be harmful if swallowed.

If swallowed consult a physician or a hospital immediately.

Change the batteries when any of the following occur:

- **volume becomes softer or weak**
- **you hear a battery signal beep**

Do NOT throw used batteries into household trash.

Return them to your hearing instrument specialist for environmentally correct disposal.

Inserting and removing your INTUIS Life

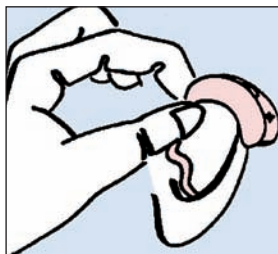
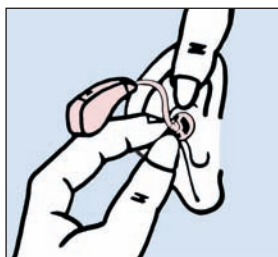
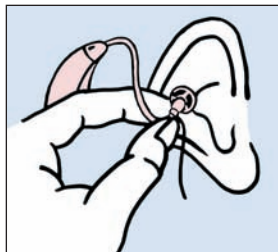

Make sure that your hearing instrument is turned off. Hold the LifeTip Adapter or earmold between your thumb and index finger and insert it carefully into your ear canal. You may find it helpful to pull your ear slightly upward or to the back. Gently work the LifeTip Adapter with the LifeTip or earmold into its proper position by adjusting it until it is firmly seated in your ear. Once inserted, you should feel whether the LifeTip Adapter with the LifeTip or earmold is placed correctly. Next, place your hearing instrument behind your ear and turn it on.

Tip:

Practice inserting and removing your hearing instrument correctly. An easy way to practice is to sit down at a table. Place a mirror in front of you and prop your elbows on the table so you can guide your hands easily and safely. This will help you stay relaxed and comfortable while you practice.

Turning your INTUIS Life on and off

Your INTUIS Life hearing system automatically turns on when a battery is inserted and the compartment door is completely closed.

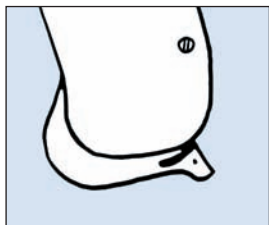

To turn off

Press the battery compartment to the rear down to the first stop to turn the instrument OFF.

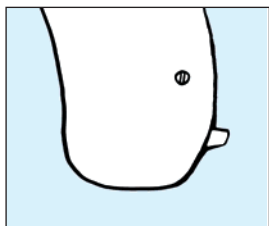

To turn on

Fully close the battery compartment to turn the instrument ON.

Maintenance and care

Your new INTUIS Life hearing system is a highly sensitive system. Proper care and handling will ensure the best possible performance.

Earwax may accumulate on your LifeTube, LifeTip or earmold. If not cleaned regularly you can damage the hearing system or cause health problems. Therefore:



1. **Caution:** Do NOT put the hearing system in water.
2. Occasionally bring your hearing system to your hearing instrument specialist to have the LifeTube or the hearing tube changed or cleaned and the system checked.

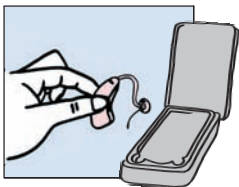

Always store your hearing system in the case provided.

Care tips:

- You should place your hearing system in a "dry aid kit" with a special moisture-attracting capsule overnight. The drying capsule draws damaging moisture out of the system.
- Your hearing instrument specialist can provide you with special care sets and drying capsules to keep your hearing system in good condition.

Important notes

- Never expose your hearing system to extreme temperatures or high humidity. Do not store it in direct sunlight. Do not wear it when taking a shower or when applying hairspray.
- As with all electrical, non gas-encapsulated systems, the hearing system must not be operated in explosion-endangered rooms.
- Do not wear your hearing system during short-wave therapy, or if you work with medical treatments that use strong magnetic or high-frequency fields, such as MRIs or X-rays.
- Make sure to turn off the system when not in use. This helps preserve your batteries.
- When not wearing your system for long periods of time, remove the batteries. This prevents leakage, which can some times occur in batteries. Replace batteries that have a leakage immediately.

Troubleshooting tips

Your INTUIS hearing system is an extremely reliable device. However, should a problem occur, this can usually be corrected quickly. Use this trouble shouting guide to sort out simple problems.

PROBLEM	CAUSE	POSSIBLE SOLUTION
System sound is weak	Weak battery	Replace with new battery
	System clogged	Clean Life Tube or earmold
System whistles	Improper seating in ear (only with standard earhook)	Try reinserting the instrument until it fits securely
	Clogged with wax or excessive wax in ears	Clean Life Tube or earmold or contact your hearing instrument specialist
	Crack in Life Tube or earmold tubing	Contact your hearing instrument specialist

PROBLEM	CAUSE	POSSIBLE SOLUTION
Sound is distorted or intermittent	Weak battery	Replace battery
"Buzzing" or "whistling" sound	Battery compartment is not completely closed	Gently close the battery compartment
	Weak battery	Replace battery
Hearing system does not work	System not turned on	Turn on system
	Battery compartment is not completely closed	Gently close the battery compartment completely
	Dead battery	Replace with new battery
	Battery polarity reversed	Make sure battery is inserted correctly
	Power-on-delay is active	Wait and check after app. 15 seconds

If you still encounter problems after trying these suggestions, consult your hearing instrument specialist.

With the CE marking Siemens confirms compliance with the European Directive 93/42/EEC concerning medical devices.

Within the European Union, the marked equipment is covered by "Directive 2002/96/EC of the European Parliament and of the Council of 27 January 2003 on waste electrical and electronic equipment. Amended by Directive 2003/108/EC" (WEEE).



Siemens
Audiologische Technik GmbH
Gebbertstraße 125
91058 Erlangen
Germany

www.hearing-siemens.com

Order-No.: A91SAT-00023-99T01-7600
Printed in Germany
0906.ANR
101 74 528